

# ROOF CASSETTE SYSTEM



STREIF's heavy duty roof cassette system is the ideal solution for mono pitched roofs, flat roofs and rooms in the roof, when buildings need to be made watertight fast.

The solid timber roof cassettes are manufactured under controlled factory conditions, and they're already felted, battened and insulated to whatever U-value is required.

Any combination of rafters is possible and battening can be provided to suit any tiling centres for concrete, clay or slate roof coverings.

The solid timber rafters are strong, very strong - at a minimum of 200mm x 60mm, C24 graded, Scots Pine, PEFC, 15% ( $\pm 3\%$ ) moisture content, and fully treated they tick all the boxes.

The roof cassettes are also large, very large - single cassettes can be up to 13m long and 2.5m wide, and using STREIF's special connection system the roof is instantly watertight and ready to go.

And the system is quick, very quick - with our highly trained crews up to 1,000m<sup>2</sup> of roof cassettes can be installed in a day, meeting the highest levels of quality and safety.

The system is suitable for timber frame, masonry or steel frame construction, and it's routinely strong enough to accept extensive green roofs.

It can also be engineered with glulam or steel purlins, and with ridge beams to give extra wide room in the roof spaces.

There's even a clever pre-cut, folding rafter system for use in the self-build market

STREIF - "Building quality quickly"

# ROOF CASSETTE SYSTEM

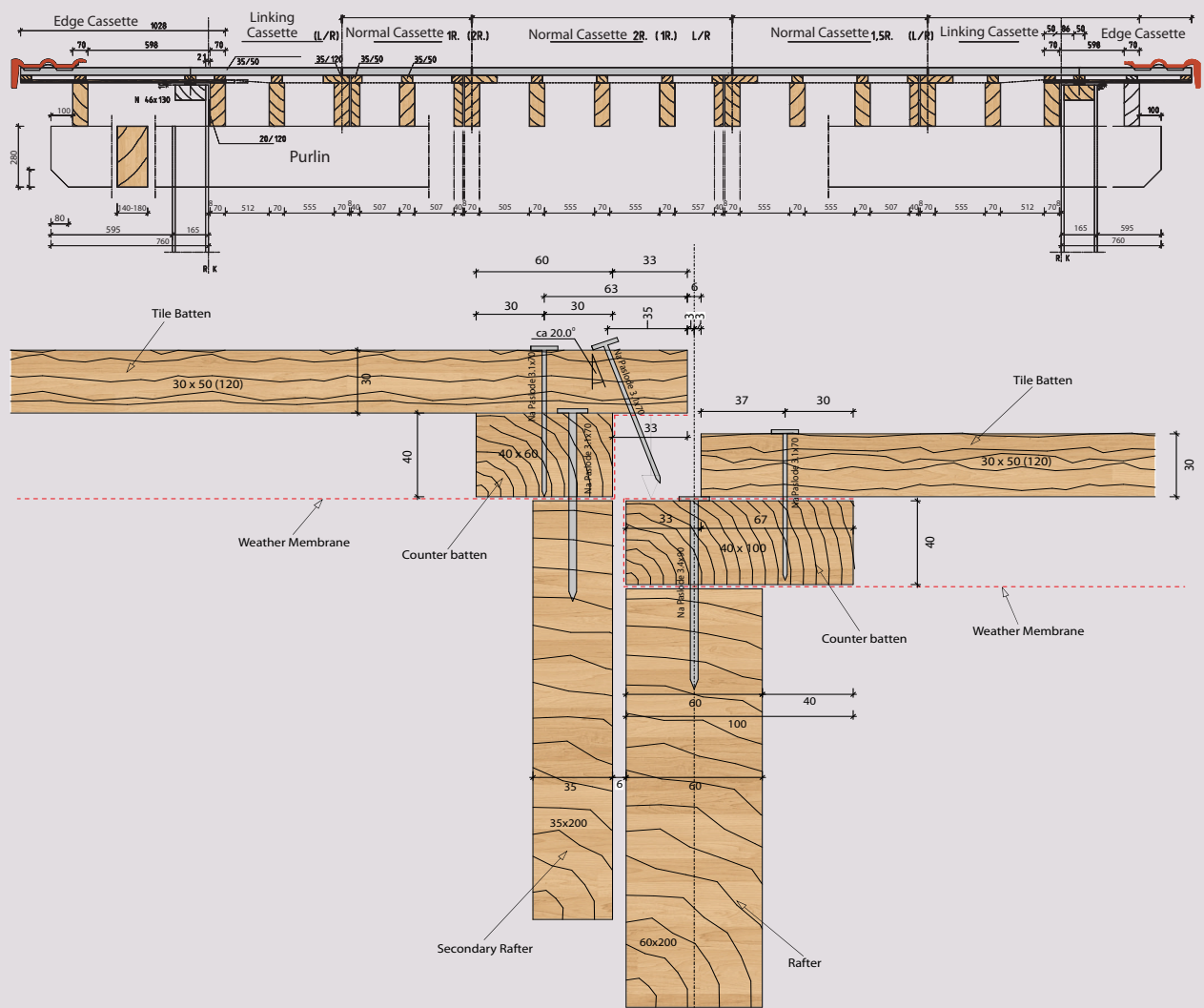

## Technical Specifications

- 100% PEFC timber product.
- Wolmanit CX10 timber treatment.
- Cassette sizes up to 13m x 2.5m.
- Solid timber construction, not lightweight I-joists or Posi-joists.
- Better strength, stability & fire resistance.
- Immediately watertight and ready to go.
- Ideal for pitched roofs and flat roofs alike.
- Supply only, supply & training, or full supply & fix with crane.
- Suitable for timber frame and masonry construction types.
- Built in lifting straps for craneage and crew safety harnesses.
- Very rapid installation rates – up to 1,000m<sup>2</sup> a day.
- Zero site waste & better site safety.
- Full structural calculations supplied.

## Options available include –

- 22mm OSB 3, or 24mm WBP EN636 spruce ply decking
- Pre-insulation with up to 200mm mineral wool, EPS or PUR.
- Multiple rafter configurations to take the highest loads.
- Full tile battening at any centres or simple fly battening.
- Profiling and decorating of exposed rafter feet and soffits.
- Full Hundegger machining capability for rafter notching.
- STREIF's unique folding rafter kits for self assembly.
- Stand alone felt and batten elements.
- Tyvek Supro weather membranes.

